

REVISIONS

NO.	DATE	DESCRIPTION	BY	CKD

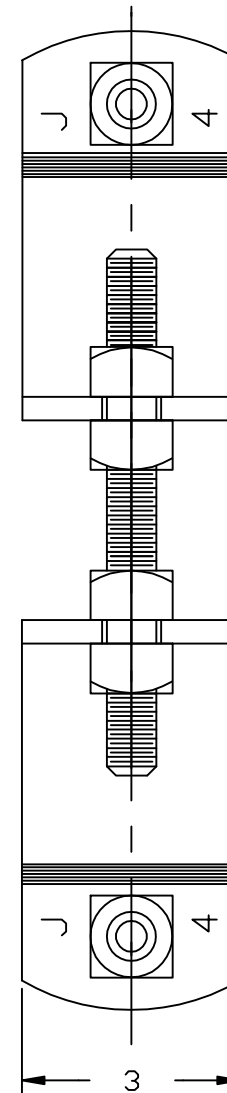
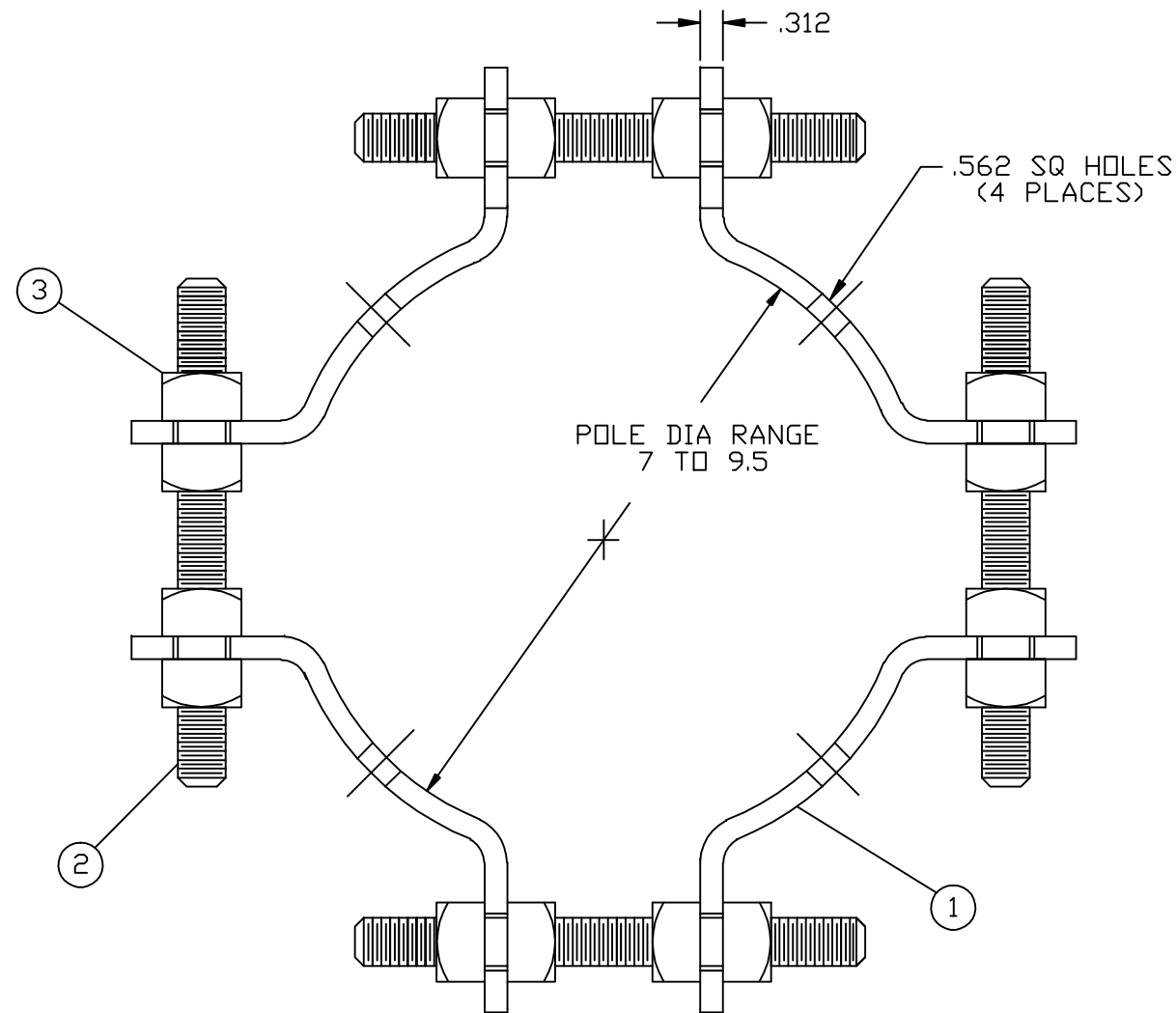

ITEM	PART NO.	DWG NO.	QTY	DESCRIPTION
1	1479-B	1479-B	4	.312 X 3 POLE BAND SECTION
2	25047.3	25047	4	.75 X 7 STUD BOLTS
3	J8564	23832	16	.75 SQUARE NUTS

NOTES:

- 1) ALL DIMENSIONS ARE REFERENCE AND ARE IN INCHES
- 2) ALL ITEMS ARE HOT DIP GALVANIZED (ASTM A-153)

All information contained in this disclosure whether patentable or otherwise comprises proprietary information of MacLean Dixie, LLC. and its unauthorized use or publication without the express written consent of MacLean Dixie, LLC. is strictly prohibited.



MACLEAN DIXIE, LLC.
 A MACLEAN POWER SYSTEMS COMPANY
 1500 RED HOLLOW RD.
 BIRMINGHAM, ALABAMA 35215

4 WAY POLE BAND ASSEMBLY
 CAT. NO. J6643

ENG. REF.

DATE: XX/XX/XX SCALE: FULL
 DWN. BY: XXX CKD. BY: XXX APR. BY:

NO. 1479-C

R/0 SH. 1 OF 1