

COMPONENT SPECIFICATION

USE OR REPRODUCTION OF THIS DRAWING FOR THE PURPOSE OF MANUFACTURING THIS ARTICLE OR ANY ARTICLES SHOWN FOR ANY PURPOSE IS STRICTLY PROHIBITED WITHOUT WRITTEN PERMISSION FROM SENIOR INDUSTRIES, INC.

SPECIFICATIONS:

MECHANICAL:

RANGE: #12-#6 COPPER GROUND WIRE

TORQUE:

SET SCREW/GROUND STUD: APPROX. 35 IN-LBS MIN.

AGENCY APPROVALS: UL/CUL FILE NO. E137532

MATERIAL:

GROUNDING BAR: .118" THICK NICKEL PLATED BRASS

STAKED STUD: NICKEL PLATED BRASS

SET SCREW: NICKEL PLATED BRASS

GREEN SCREWS: 300 SERIES STAINLESS STEEL

CONTACT PLATE: .045" THICK 300 SERIES STAINLESS STEEL

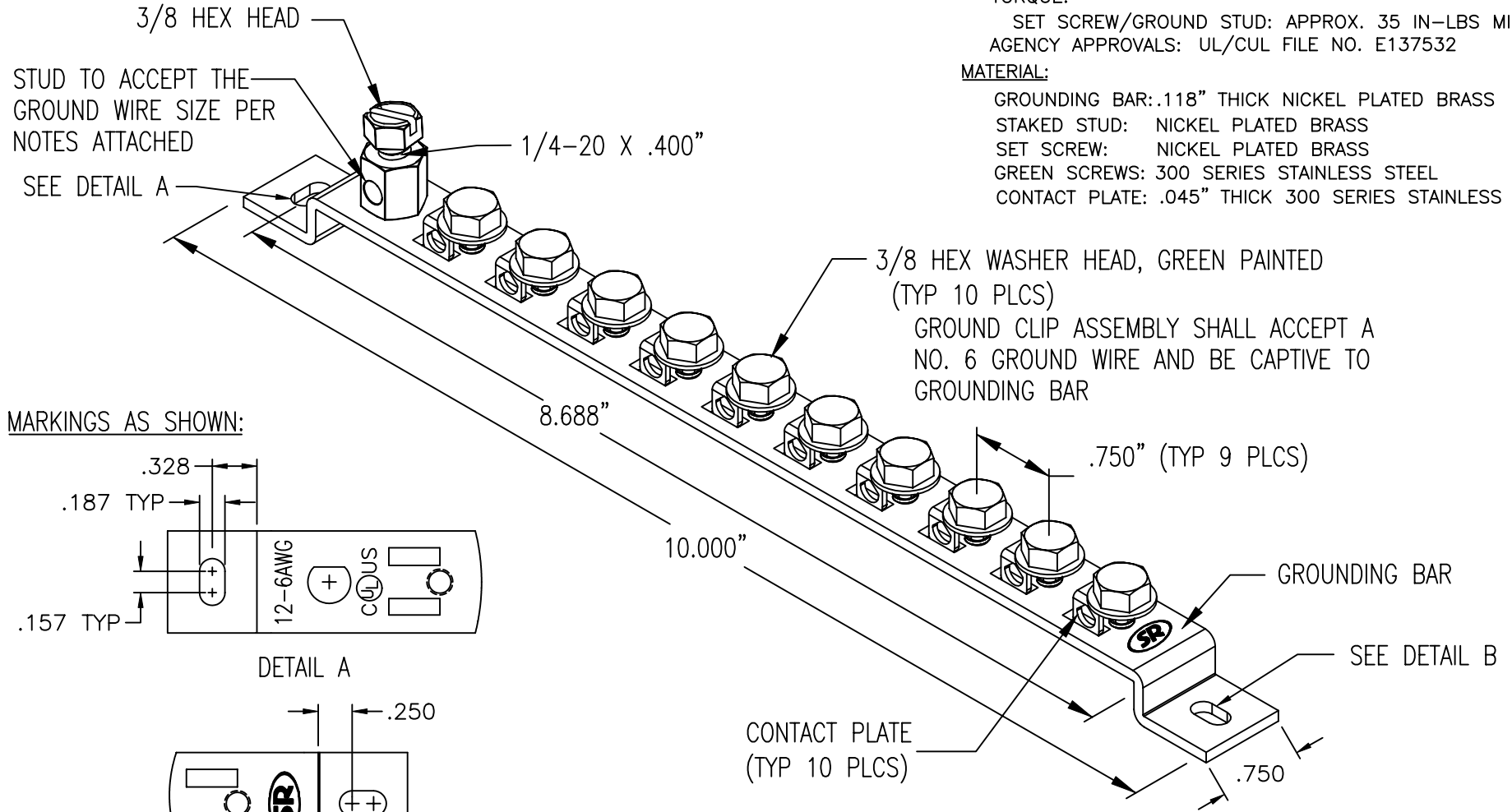

MARKINGS AS SHOWN:

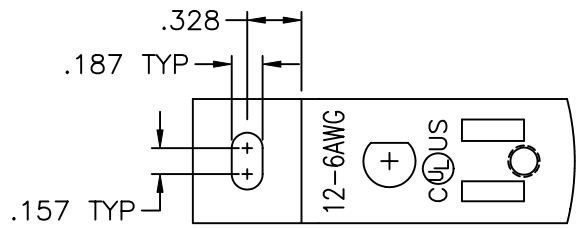

DETAIL A

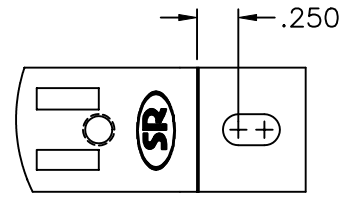

DETAIL B



DESIGNED:			SYM.	DATE:	DESCRIPTION OF REVISIONS:	DRAWN:	APPD:	TOLERANCE:	PART NO:	SI-2010
DRAWN:	HV	05/18/05	▲	03.20.07	NEW	GAT	JF	TO 2 DECIMAL PLACE: ±	TITLE:	MULTIPLE GROUNDING BAR
CHECKED:	GAT	03/20/07	▲	.	.			TO 3 DECIMAL PLACES: ±	SHEET:	1 OF 1
APPROVED:	JF	03/20/07	▲	.	.			AS ANGLES: ±		
3RD ANGLE	UNIT: inches		SCALE: 1:1	REV. A						