

COMPONENT SPECIFICATION

USE OR REPRODUCTION OF THIS DRAWING FOR THE PURPOSE OF MANUFACTURING THIS ARTICLE OR ANY ARTICLES SHOWN FOR ANY PURPOSE IS STRICTLY PROHIBITED WITHOUT WRITTEN PERMISSION FROM SENIOR INDUSTRIES, INC.

SPECIFICATIONS:

ELECTRICAL:

CONTACT RATING:

3 CONTACT	15A @ 125VAC
4 CONTACT	10A @ 125VAC
5 CONTACT	7.5A @ 125VAC
7 CONTACT	5A @ 125VAC
CONTACT RESISTANCE:	5 MILLIOHMS MAX.
INSULATION RESISTANCE:	5000 MEGOHMS MIN. @ 500VDC
DIELECTRIC STRENGTH:	1400VAC
CAPACITANCE:	
3 CONTACT	4pF MAX.
4 CONTACT	7pF MAX.
5 CONTACT	7pF MAX.
7 CONTACT	9pF MAX.

MECHANICAL:

INSERTION FORCE:	1.0 - 8.0 Kg
WITHDRAWAL FORCE:	1.0 - 8.0 Kg

ENVIRONMENTAL:

OPERATING TEMPERATURE: -55°C TO +70°C

DRAWING NUMBER	NUMBER OF PINS
-3-X-X	3
-4-X-X	4
-5-X-X	5
-7-X-X	7

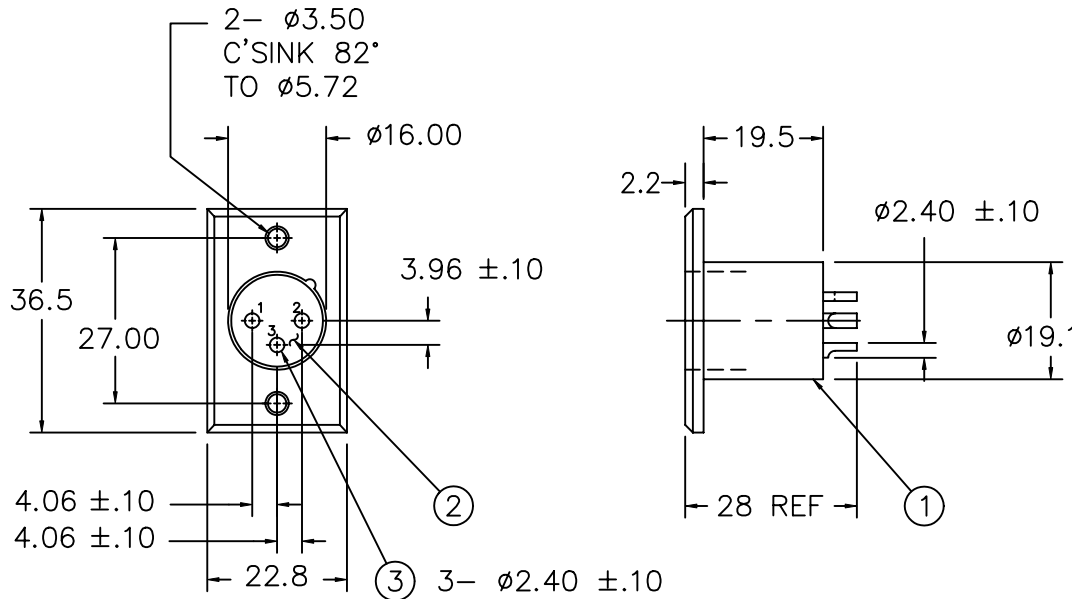

SI-302-3-X-X SHOWN

NOTES:

- 2nd 'X' IN PART NUMBER DENOTES HOUSING FINISH:
N-NICKEL; B-BLACK NICKEL
- 3rd 'X' IN PART NUMBER DENOTES PINS PLATING:
1-SILVER; 3-GOLD

ITEM	PART	QT'Y	MATERIAL/FINISH
1	HOUSING	1	ZINC DIE-CAST; NICKEL OR BLACK NICKEL PLATED
2	INSERT INSULATOR	1	PPT; GRAY
3	PIN	3	BRASS; SILVER OR GOLD PLATED



SENIOR INDUSTRIES, INC.

DESIGNED:		SYM.	DATE:	DESCRIPTION OF REVISIONS:	DRAWN:	APPD:	TOLERANCE:	PART NO:	SI-302-X-X-X
DRAWN:	KRM 04/08/93	Δ	09.01.93	NEW	JF	JF			
CHECKED:	JF 09/01/93	Δ	03.07.95	Ch'd hole sizes and spacing to match parts	JF	JF	TO 1 DECIMAL PLACE: \pm .4 TO 2 DECIMAL PLACES: \pm .20	TITLE:	XLR RECEPTACLE
APPROVED:	JF 09/01/93	Δ	07.06.05	Notes corr'd, Spec info added, Material spec corr	GAT	JF			
3RD ANGLE		UNIT:	mm	SCALE:	1:1	REV:	C	SHEET:	1 OF 1