

UNLESS OTHERWISE SPECIFIED, ALL DIMENSIONS ARE IN METRIC.  
 DIMENSIONS OTHER THAN SIZE OF RAW MATERIAL SHALL BE  
 HELD AS FOLLOWS WHEN EXPRESSED.

TO 1 DECIMAL PLACE ±0.4  
 TO 2 DECIMAL PLACES ±0.20  
 AS ANGLES ?

ISSUE	DATE	AUTH.
A	09/01/93	A1081

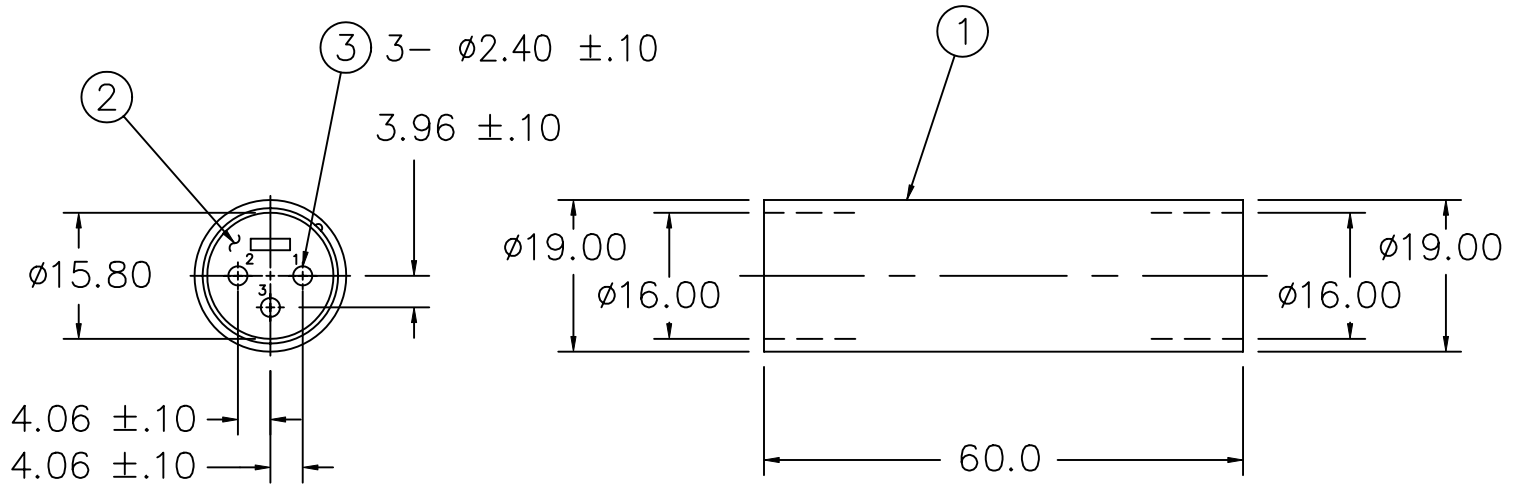

SI-312-3-X-X SHOWN

WIRING SCHEMATIC	DRAWING NUMBER	NUMBER OF PINS
PIN 1 - PIN 1	-3-X-X	3
PIN 2 - PIN 2	-4-X-X	4
PIN 3 - PIN 3	-5-X-X	5
	-7-X-X	7

ITEM	PART	MATERIAL/FINISH
1	HOUSING	ZINC DIE CAST; NICKEL, BLACK NICKEL, OR GOLD PLATED
2	INSERT INSULATOR	PPO-1 UL94V-0 RATED; GRAY
3	PIN	BRASS; SILVER OR GOLD PLATED



TITLE: <b>XLR ADAPTER</b>		PART NO: <b>SI-312-X-X-X</b>	
DATE: 04/08/93	DRAWN: KRM	CHKD:	SCALE: 1/1
			SHEET: 1 OF 1