

COMPONENT SPECIFICATION

USE OR REPRODUCTION OF THIS DRAWING FOR THE PURPOSE OF MANUFACTURING THIS ARTICLE OR ANY ARTICLES SHOWN FOR ANY PURPOSE IS STRICTLY PROHIBITED WITHOUT WRITTEN PERMISSION FROM SENIOR INDUSTRIES, INC.

WIRING SCHEMATIC	
SOCKET 1	- GROUND
SOCKET 2	- TIP
SOCKET 3	- RING

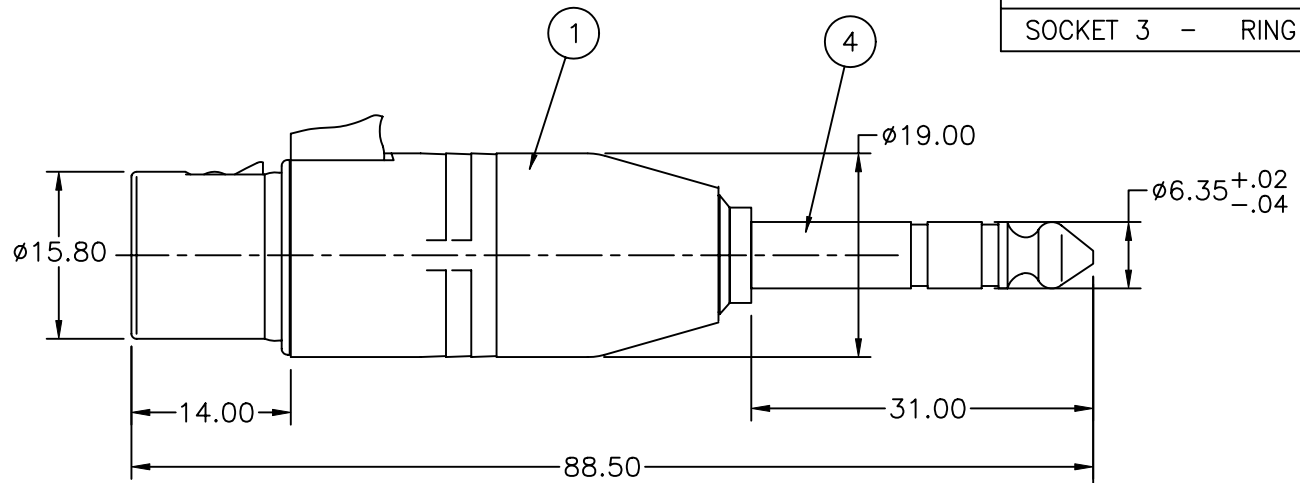
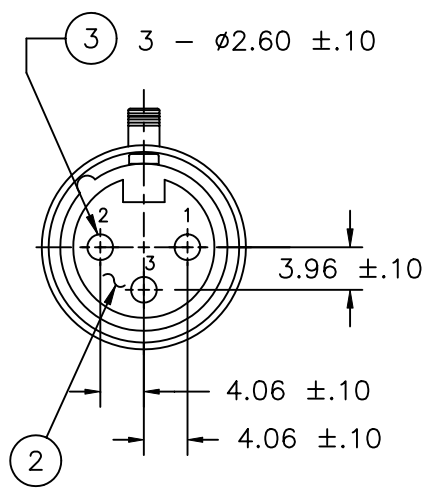

NOTES:

- 1st 'X' IN PART NUMBER DENOTES HOUSING FINISH:  
N-NICKEL; B-BLACK NICKEL; G-GOLD
- 2nd 'X' IN PART NUMBER DENOTES SOCKETS PLATING:  
1-SILVER; 3-GOLD

ITEM	PART	MATERIAL/FINISH
1	HOUSING	ZINC DIE CAST; NICKEL, BLACK NICKEL, OR GOLD PLATED
2	INSERT INSULATOR	PPO-1 UL94V-0 RATED; BLACK
3	SOCKET	PHOSPHOR BRONZE; SILVER OR GOLD PLATED
4	PHONE PLUG	BRASS; NICKEL PLATED



DESIGNED:		SYM.	DATE:	DESCRIPTION OF REVISIONS:	DRAWN:	APPD:	TOLERANCE:	PART NO:	SI-315-X-X		
DRAWN:	GAT 06/26/08	▲	09.01.93	NEW	KRM	JF				TO 1 DECIMAL PLACE: ±0.4 TO 2 DECIMAL PLACES: ±0.20 AS ANGLES: ±1/2°	TITLE:
CHECKED:	GAT 06/26/08	▲	06.26.08	New indicator. Improved design.	GAT	JF	SHEET:	1 OF 1			
APPROVED:	JF 06/26/08	▲									
3RD ANGLE		UNIT: mm		SCALE: 1:1	REV. B						