

UNLESS OTHERWISE SPECIFIED, ALL DIMENSIONS ARE IN METRIC.
DIMENSIONS OTHER THAN RAW MATERIAL SHALL BE HELD AS
FOLLOWS WHEN EXPRESSED.

TO 1 DECIMAL PLACE $\pm .3$
TO 2 DECIMAL PLACES $\pm .12$
AS ANGLES $\pm 1/2^\circ$

ISSUE	DATE
A	03/01/96

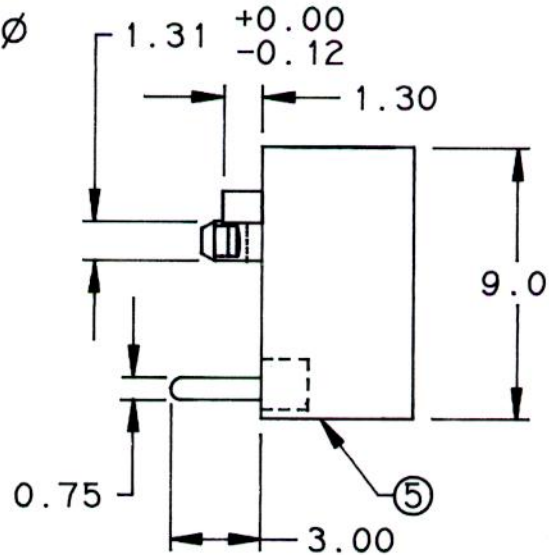
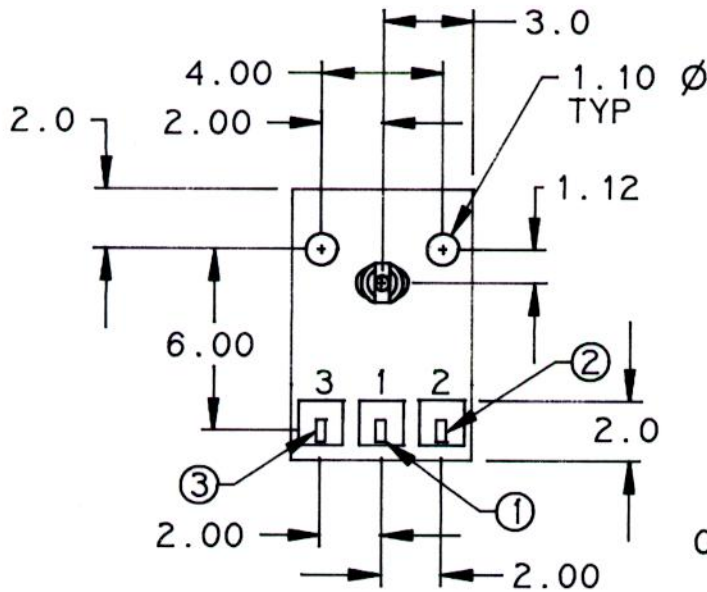
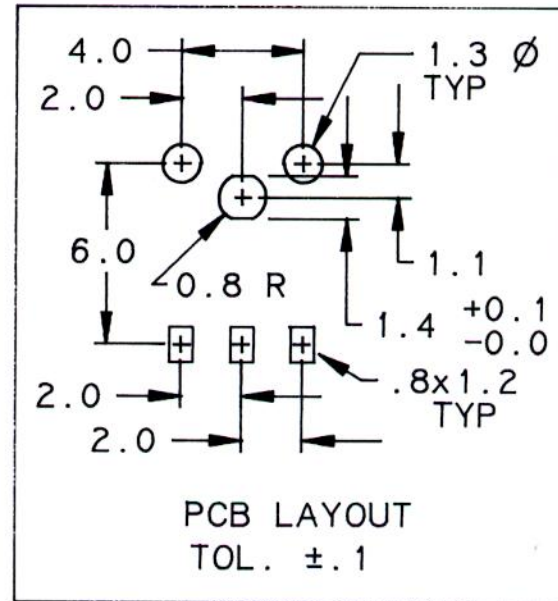
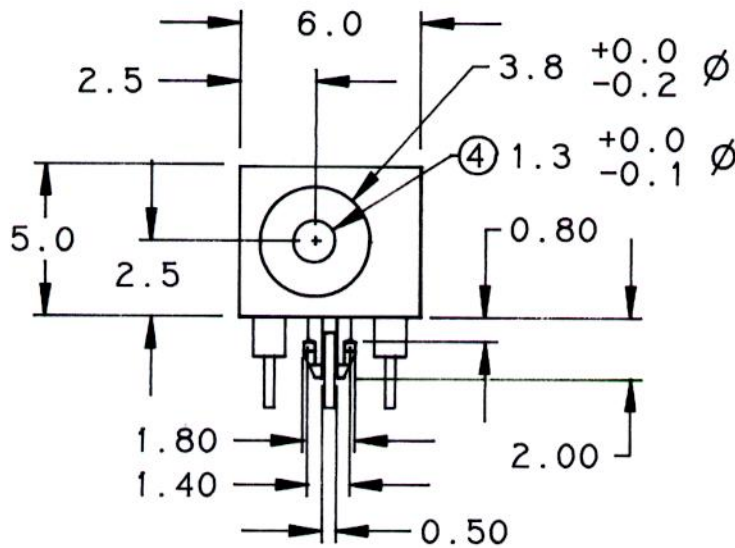

ITEM	DESCRIPTION	MATERIAL/FINISH
1	PIN TERMINAL	BRASS, SILVER PLATED 0.3T
2	SLEEVE SPRING	PHOSPHOR BRONZE, SILVER PLATED 0.3T
3	SLEEVE SHUNT	BRASS, SILVER PLATED 0.3T
4	PIN	BRASS, SILVER PLATED
5	HOUSING	PPS UL94V0

SR SENIOR INDUSTRIES, INC.

TITLE: POWER JACK PART NO: SI-525
DATE: 03/01/96 DRAWN: H V CHKD: SHEET: 1 OF 1
SCALE: 4/1