

UNLESS OTHERWISE SPECIFIED, ALL DIMENSIONS ARE IN INCHES.

TO 2 DEC. PLS. ±.01
TO 3 DEC. PLS. ±.005
AS ANGLES ±1°

ISSUE

DATE

A

01/13/99

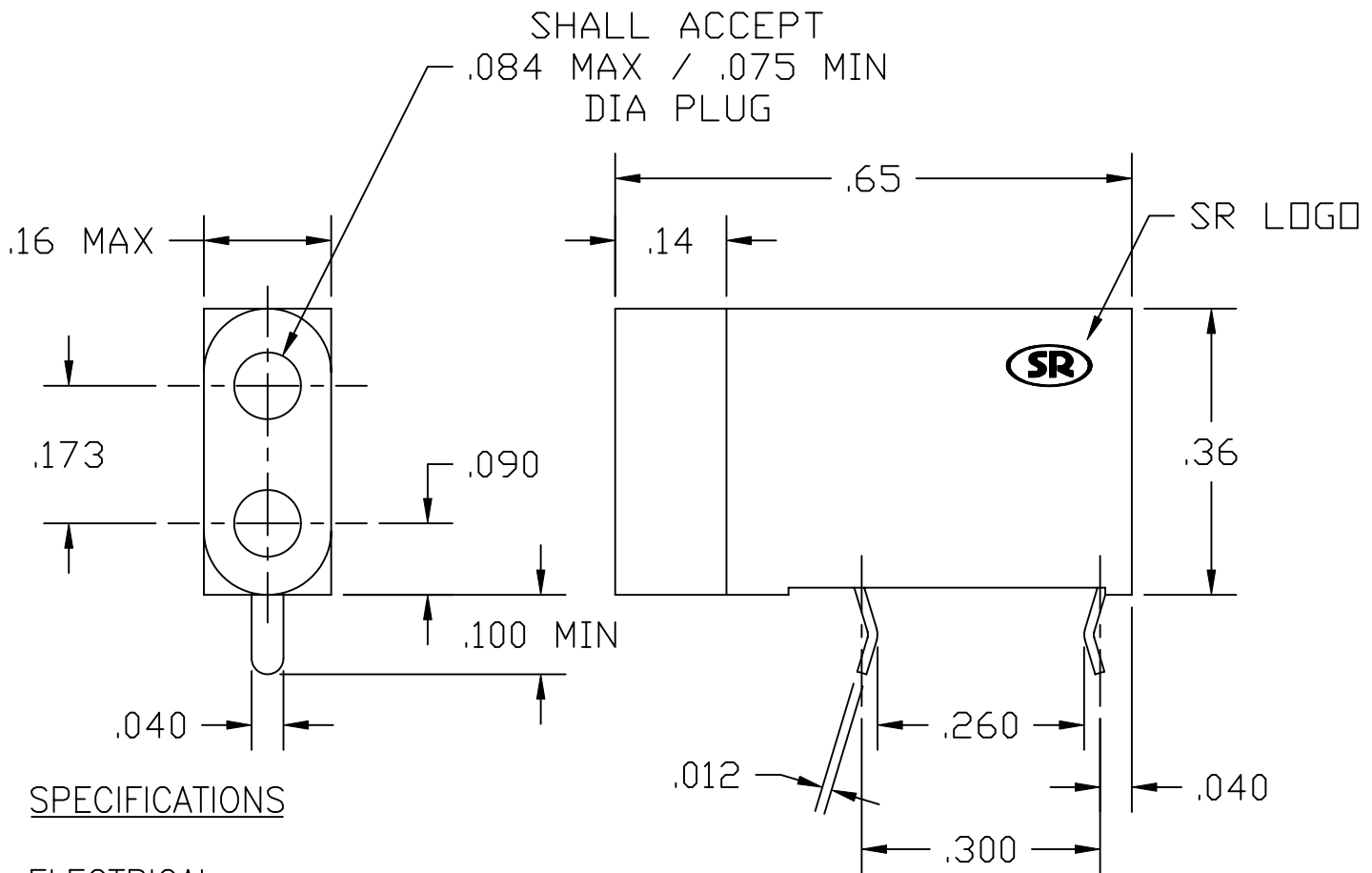

SPECIFICATIONS

ELECTRICAL

CONTACT RATING: 6.3 AMPS

CONTACT RESISTANCE: 30 MILLIOHMS MAX

INSULATION RESISTANCE: 10,000 MEGOHMS MIN AT 500 VDC

MECHANICAL

WITHDRAWAL FORCE: 0.2 KG MIN USING .080" ±.001 Ø PIN

SOLDERABILITY: JACK SHALL PASS SOLDERABILITY TEST PER TP1101 WITH MINIMUM 95% WETTING AT A SOLDER TEMPERATURE OF 245±5°C AND A DWELL TIME OF 5±1 SECONDS

MATERIAL

HOUSING: POLYCARBONATE, UL94V-0 RATED

CONTACTS AND LEADS: 100 MICROINCH MIN TIN PLATED COPPER ALLOY

ENVIRONMENTAL

OPERATING TEMPERATURE: -25° TO +70°C

X SUFFIX DENOTES HOUSING COLOR OPTIONS



TITLE:

TIP JACK

PART NO:

SI-526T-X

DATE:

01/11/99

DRAWN:

GAM

CHKD:

SCALE:

4/1

SHEET:

1 OF 1