

1

2

3

4

5

COMPONENT SPECIFICATION

USE OR REPRODUCTION OF THIS DRAWING FOR THE PURPOSE OF MANUFACTURING THIS ARTICLE OR ANY ARTICLES SHOWN FOR ANY PURPOSE IS STRICTLY PROHIBITED WITHOUT WRITTEN PERMISSION FROM SENIOR INDUSTRIES, INC.

"1/2" AND "HOLE" MARKING ON THIS SIDE IN THE APPROPRIATE SIZE AND LOCATION.

"5/16" AND "L" MARKING ON THIS SIDE IN THE APPROPRIATE SIZE AND LOCATION.

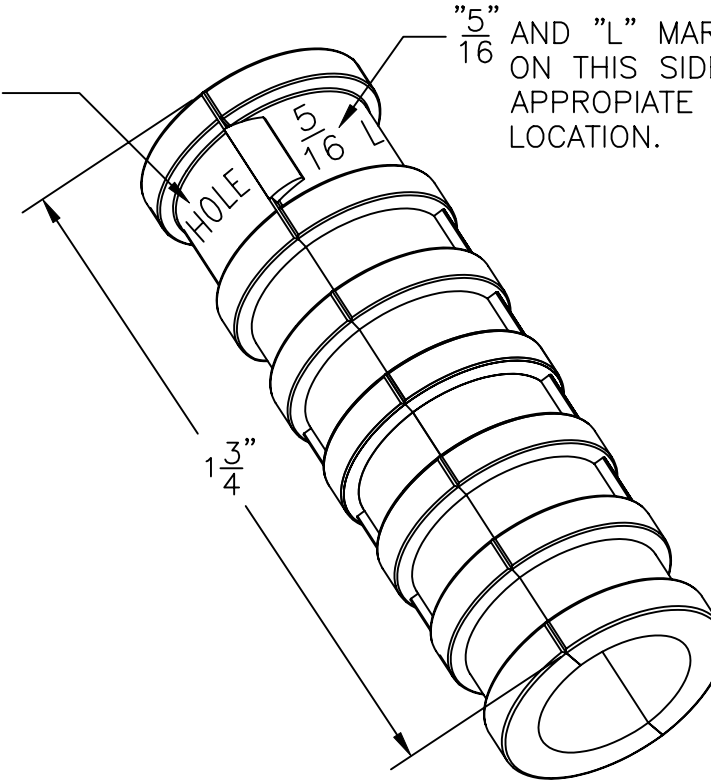

NOTES:

- 1. MATERIAL: RUSTPROOF ZINC ALLOY.
- 2. SIZE: 5/16" LONG; HOLE SIZE: 1/2".
- 3. PART CONSISTS OF TWO ALLOY SLEEVES HELD TOGETHER BY INTERLOCKING TABS.
- 4. TAPERED RINGS PROVIDE ADDITIONAL HOLDING POWER IN SOFTER BASE MATERIALS.
- 5. INTERNAL THREADS TO MATE WITH LAG SCREW THREADS.



SENIOR INDUSTRIES, INC.

DESIGNED:			SYM.	DATE:	DESCRIPTION OF REVISIONS:	DRAWN:	APPD:	TOLERANCE:	PART NO:	SI-LS-516
DRAWN:	GAT	11/12/09		11.12.09	NEW	GAT	JF			
CHECKED:	GAT	11/12/09		.	.			TO 2 DECIMAL PLACE: ±	TITLE:	LAG SHIELD 5/16"
APPROVED:	JF	11/12/09		.	.			TO 3 DECIMAL PLACES: ±	SHEET:	1 OF 1
3RD ANGLE		UNIT:	inches	SCALE:	3/1	REV.	A	AS ANGLES: ±		