

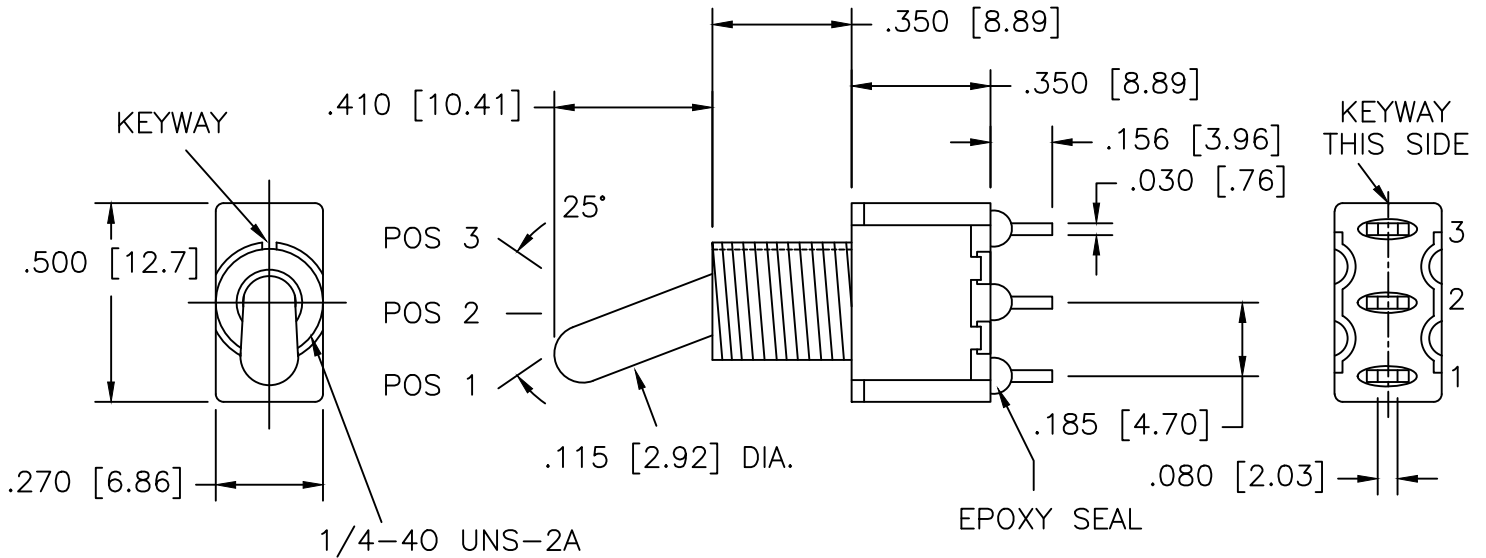



UNLESS OTHERWISE SPECIFIED, ALL DIMENSIONS ARE IN INCHES [MM].

TO 1 DECIMAL PLACE ±.2
 TO 2 DECIMAL PLACES ±.10
 AS ANGLES ±

ISSUE	DATE
B	09/29/04
C	02/19/08
D	05/20/13

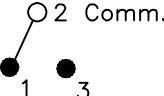

SRMT-8013-SEBQE SHOWN

MODEL NO.	SWITCHING POSITION		
			
8013	ON	NONE	ON
8013A	ON	NONE	MOM
8014	ON	OFF	ON
8014A	MOM	OFF	MOM
8014B	ON	OFF	MOM
CONN. TERMS	2-3	OPEN	2-1
SCHEMATIC	SPDT 		

NON-SHORTING TYPE

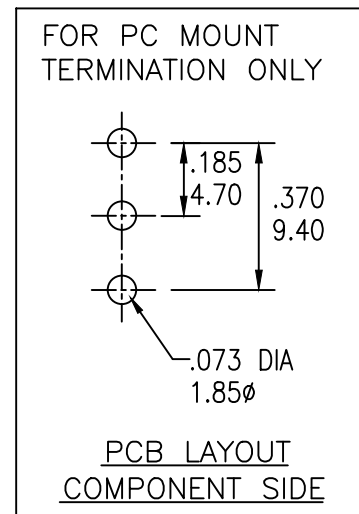

TITLE: SRMT 8013/8014 TOGGLE SWITCHES

PART NO: SEE CHART

DATE: 03/05/01

DRAWN: GAT

CHKD: JF

SCALE: 2/1

SHEET: 1 OF 7

UNLESS OTHERWISE SPECIFIED, ALL DIMENSIONS ARE IN INCHES [MM].

TO 1 DECIMAL PLACE ±.2
 TO 2 DECIMAL PLACES ±.10
 AS ANGLES ±

ISSUE	DATE
B	09/29/04
C	02/19/08
D	05/20/13

SPECIFICATIONS

ELECTRICAL

CONTACT RATING:

SILVER: 5A @ 120 VAC OR 28 VDC, 2A @ 250 VAC

GOLD: 0.4 VA MAX. @ 20 V MAX. (AC OR DC)

CONTACT RESISTANCE: 10 MILLIOHMS MAX.

INSULATION RESISTANCE: 1,000 MEGOHMS MIN. AT 500 VDC

DIELECTRIC STRENGTH: 1,000 VRMS

MECHANICAL

LIFE: 40,000 CYCLES

ENVIRONMENTAL

OPERATING TEMPERATURE: -30°C TO +85°C

MATERIAL

CASE: DAP, UL 94V-0

HOUSING: STAINLESS STEEL

ACTUATOR: BRASS, CHROME PLATED

BUSHING: BRASS, NICKEL PLATED

SUPPORT: BRASS, TIN PLATED

CONTACT/TERMINALS: COPPER ALLOY, SILVER OR GOLD PLATED

REGULATORY

UL AND CANADA RECOGNIZED COMPONENT. UL/CUL FILE NO. E173084.

PART NUMBER BUILDER:

SERIES	MODEL NO.	ACTUATOR	BUSHING	TERMINATION	CONTACT PLATING	SEAL	VERTICAL SUPPORT BRACKET
SRMT	□□□□□	□	□	□	□	□	□
	8013	S (STD)	BLANK (Z/Z1 ONLY)		Q (SILVER)	BLANK	BLANK
	8013A	T	E (STD - THD)		R (GOLD)	E (EPOXY)	S20
	8014	X (LONG)	E1 (STD - THD) (U ONLY)	B (SOLDER LUG) C (PC MOUNT) D (QUICK CONNECT) D1 (WIRE WRAP - .736) D2 (WIRE WRAP - .953) D3 (WIRE WRAP - .415) D4 (WIRE WRAP - 1.062)			S60
	8014A	W (LONG)	E2 (STD - THD) (U ONLY)				
	8014B	V (LONG)	M (STD - NON-THD)				
		U (FLATTED)	M1 (STD - NON-THD)(U ONLY)				
		U2 (FLATTED)	M2 (STD - NON-THD)(U ONLY)				
		Z (LARGE TOGGLE)	F (THD)				
		Z1 (LARGE)	N (NON-THD)				
		Y (PLASTIC)	G (HIGH TORQUE)				
		LL1 (LOCKING LEVER)	H (HIGH TORQUE)				
			J (LONG)				
			K (METRIC)				
			L (SPASH-PROOF)				



TITLE: SRMT 8013/8014 TOGGLE SWITCHES

PART NO: SEE CHART

DATE: 03/05/01

DRAWN: GAT

CHKD: JF

SCALE: N/A

SHEET: 2 OF 7

UNLESS OTHERWISE SPECIFIED, ALL DIMENSIONS ARE IN INCHES [MM].

TO 1 DECIMAL PLACE ±.2
 TO 2 DECIMAL PLACES ±.10
 AS ANGLES ±

ISSUE	DATE
B	09/29/04
C	02/19/08
D	05/20/13

ACTUATOR OPTIONS

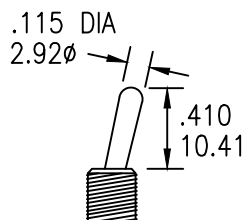

S (STD)

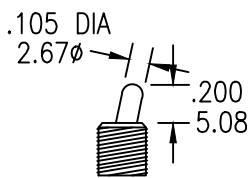

T

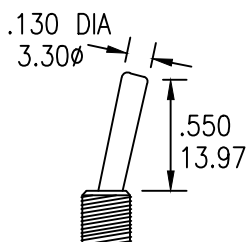

X (LONG)

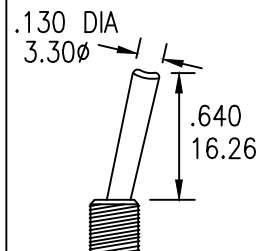

V (LONG)

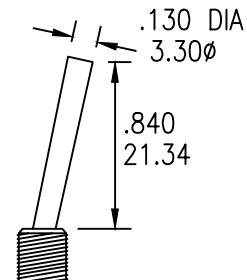

W (LONG)

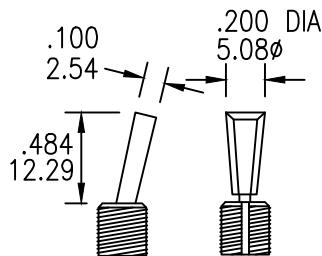

U (FLATTED)

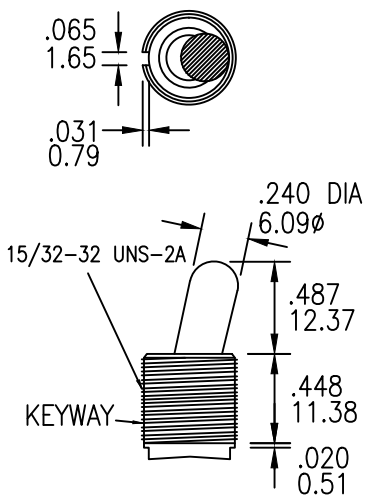

Z (LARGE TOGGLE)

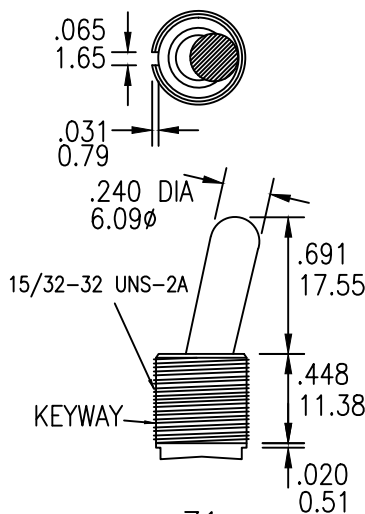

Z1

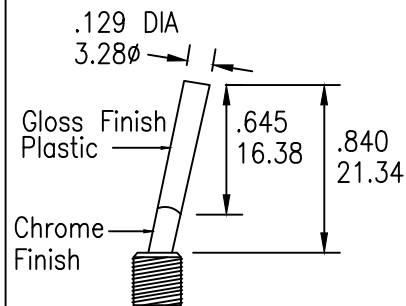

Y (PLASTIC)

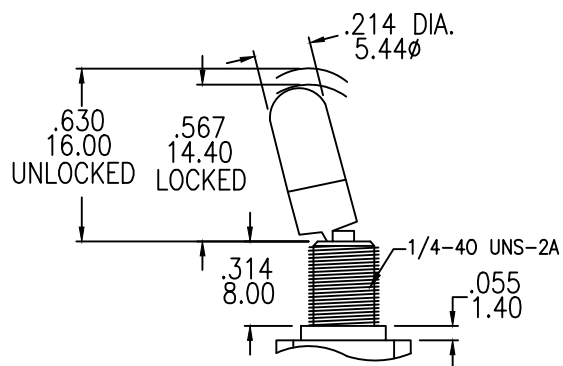

LL1 (LOCKING LEVER)

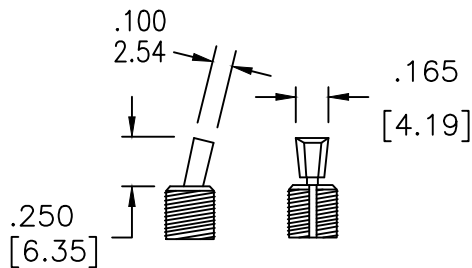

U2 (FLATTED)



TITLE: SRMT 8013/8014 TOGGLE SWITCHES

PART NO: SEE CHART

DATE: 03/05/01

DRAWN: GAT

CHKD: JF

SCALE: N/A

SHEET: 3 OF 7

UNLESS OTHERWISE SPECIFIED, ALL DIMENSIONS ARE IN INCHES [MM].
 TO 1 DECIMAL PLACE ±.2
 TO 2 DECIMAL PLACES ±.10
 AS ANGLES ±

ISSUE	DATE

BUSHING OPTIONS

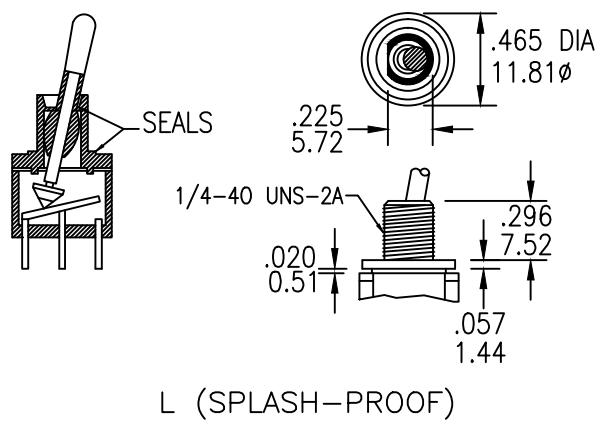
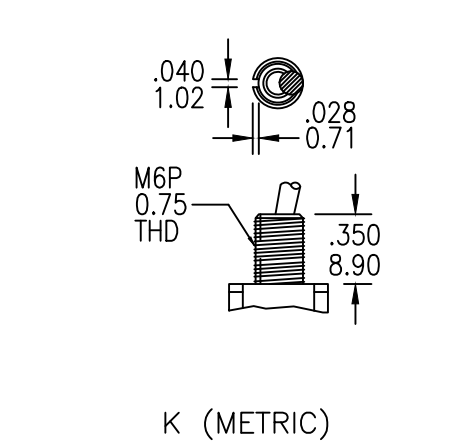
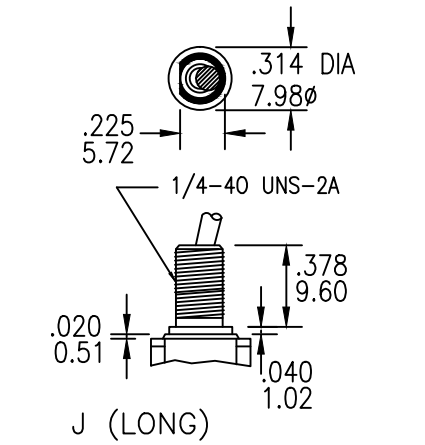
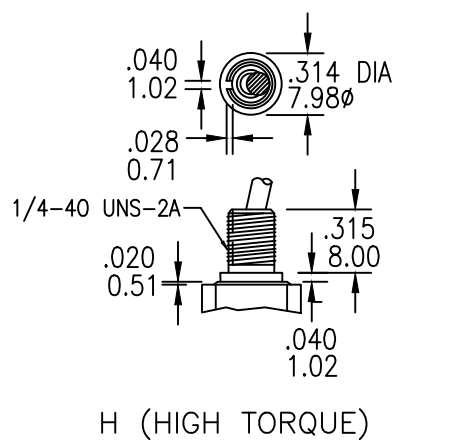
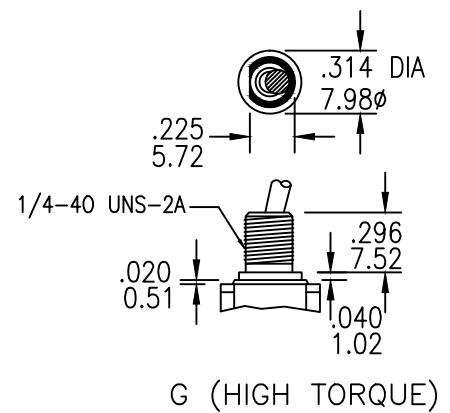
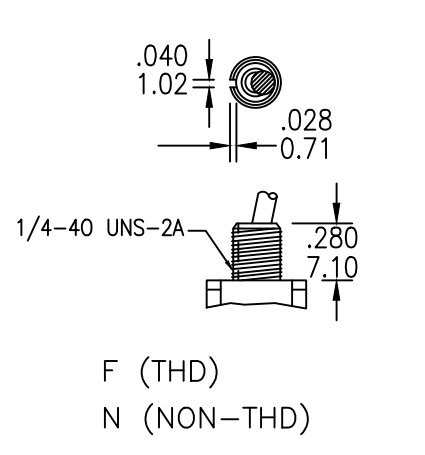
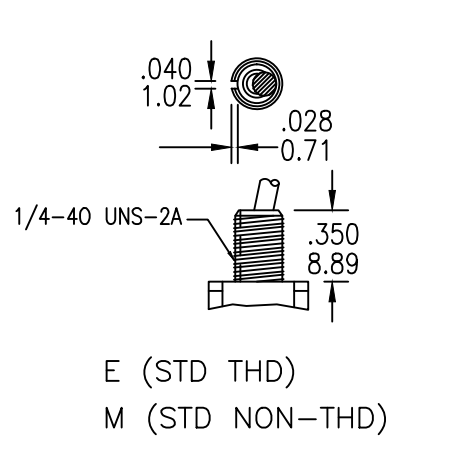

USE WITH 'U' & 'U2' (FLATTED) ACTUATOR ONLY

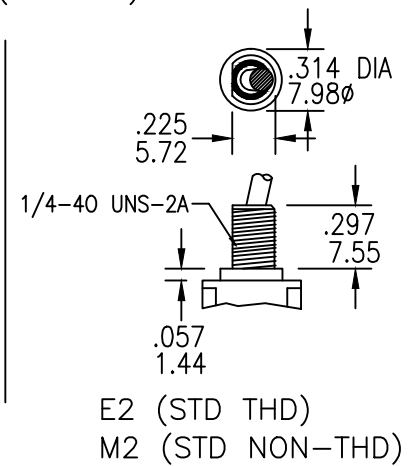
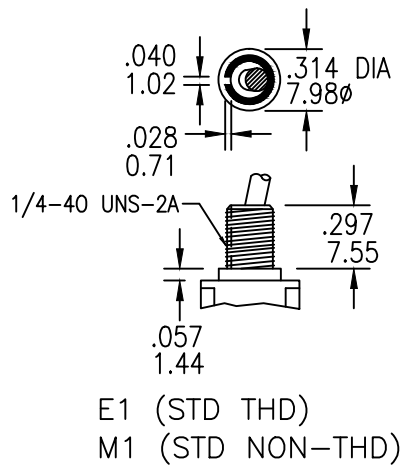

TITLE: SRMT 8013/8014 TOGGLE SWITCHES

PART NO: SEE CHART

DATE: 03/05/01

DRAWN: GAT

CHKD: JF

SCALE: N/A

SHEET: 4 OF 7

UNLESS OTHERWISE SPECIFIED, ALL DIMENSIONS ARE IN INCHES [MM].

TO 1 DECIMAL PLACE ±.2
 TO 2 DECIMAL PLACES ±.10
 AS ANGLES ±

ISSUE	DATE
B	09/29/04
C	02/19/08
D	05/20/13

TERMINATION OPTIONS

SOLDER LUG

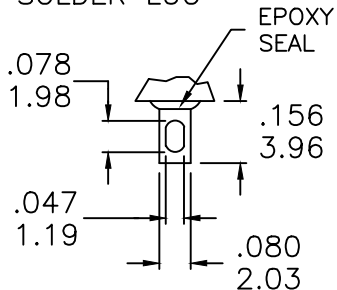

B

PC MOUNT

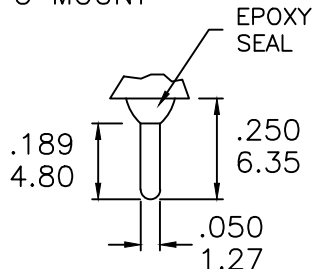

.030 [0.76] THK

C

QUICK CONNECT

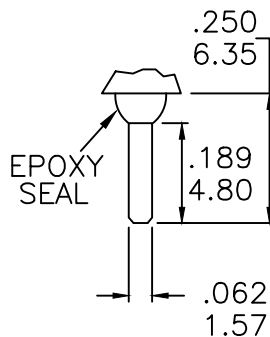

.030 [0.76] THK

D

WIRE WRAP

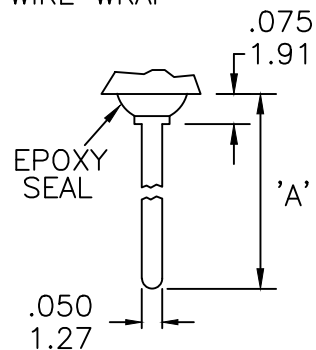

.030 [0.76] THK

	'A'
D1	.736(18.70)
D2	.953(24.20)
D3	.415(10.54)
D4	1.062(26.97)

VERTICAL SUPPORT BRACKET

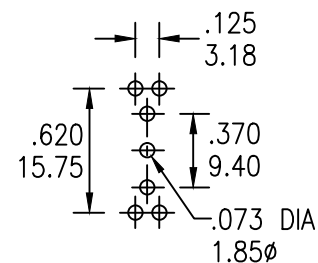
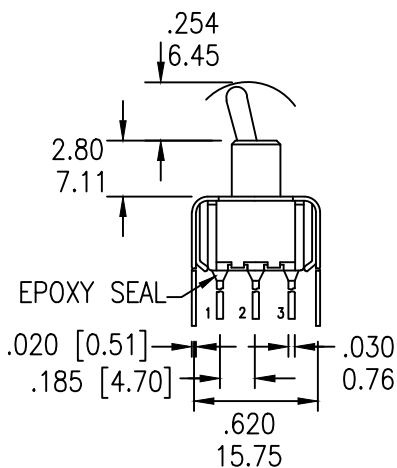
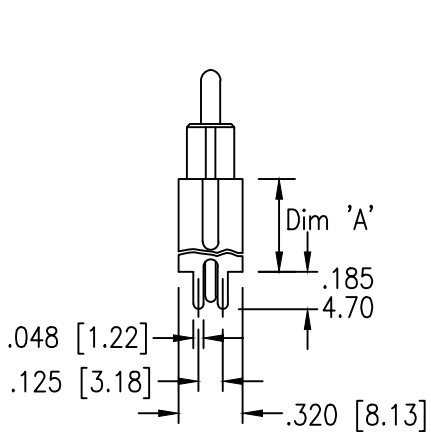

	'A'
S20	.460 [11.68]
S60	.630 [16.00]



TITLE: SRMT 8013/8014 TOGGLE SWITCHES

PART NO: SEE CHART

DATE: 03/05/01

DRAWN: GAT

CHKD: JF

SCALE: N/A

SHEET: 5 OF 7

UNLESS OTHERWISE SPECIFIED, ALL DIMENSIONS ARE IN INCHES [MM].

TO 1 DECIMAL PLACE ±.2
 TO 2 DECIMAL PLACES ±.10
 AS ANGLES ±

ISSUE	DATE
C	02/19/08
D	05/20/13

STANDARD NUTS

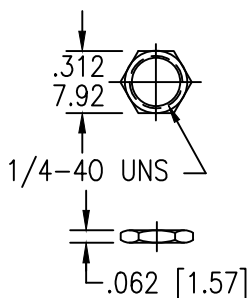

STD FOR E, F, G,
H, AND L OPTIONS

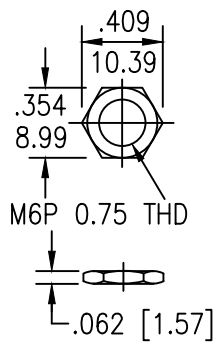

STD FOR K OPTION

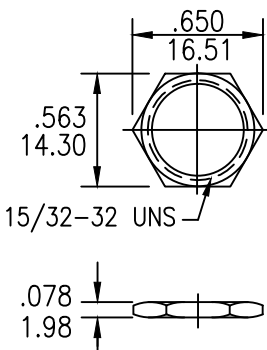

STD FOR Z
AND Z1 OPTIONS

OPTIONAL NUTS

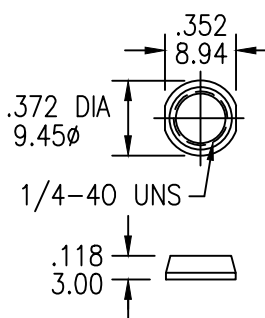

DRESS NUT

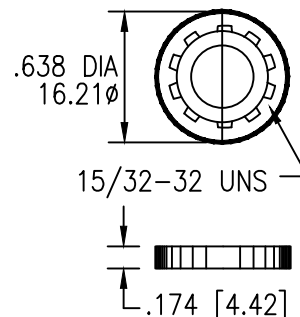

KNURLED

LOCK WASHER

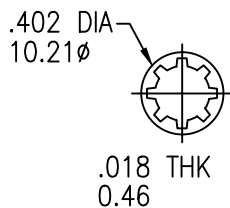

STD FOR E AND F

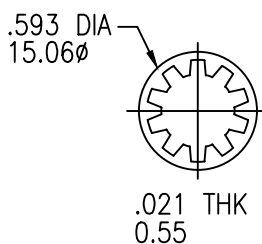

STD FOR Z AND Z1 OPTIONS

LOCKING RING

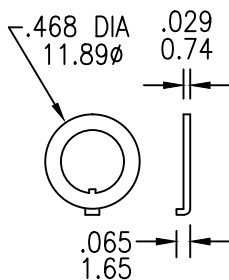

STD

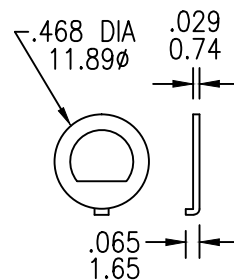

STD FOR G
AND J OPTIONS.

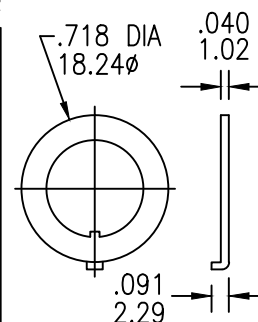

STD FOR Z
AND Z1 OPTIONS.

PANEL MOUNTING

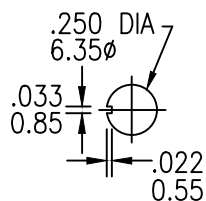

FOR BUSHING E, M, F, N, AND H OPTIONS

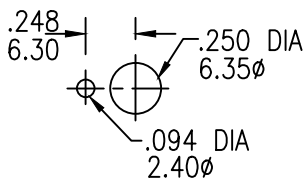
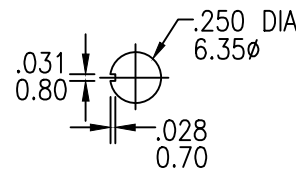
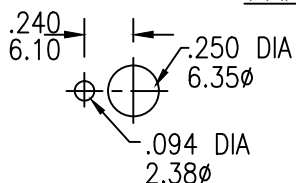

FOR BUSHING K OPTION

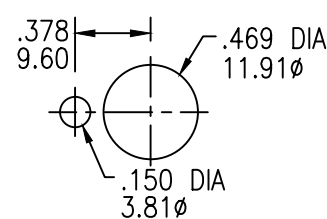
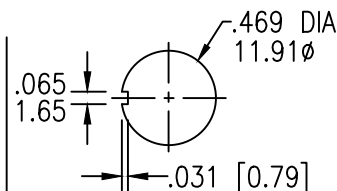

FOR ACTUATOR Z AND Z1 OPTIONS



TITLE:
SRMT 8013/8014 TOGGLE SWITCHES

PART NO:
SEE CHART

DATE:
03/05/01

DRAWN:
GAT

CHKD:
JF

SCALE:
N/A

SHEET:
6 OF 7

UNLESS OTHERWISE SPECIFIED, ALL DIMENSIONS ARE IN INCHES [MM].

TO 1 DECIMAL PLACE ±.2
 TO 2 DECIMAL PLACES ±.10
 AS ANGLES ±

ISSUE	DATE
B	09/29/04
C	02/19/08
D	05/20/13

NOTE: OPTIONAL TOGGLE CAP AVAILABLE.

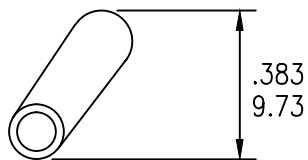

STD FOR S OPTION

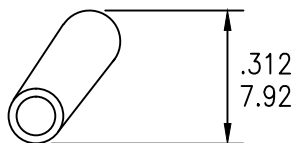

STD FOR T OPTION



**SENIOR
INDUSTRIES, INC.**

TITLE:
SRMT 8013/8014 TOGGLE SWITCHES

PART NO:
SEE CHART

DATE:
03/05/01

DRAWN:
GAT

CHKD:
JF

SCALE:
N/A

SHEET:
7 OF 7