

UNLESS OTHERWISE SPECIFIED, ALL DIMENSIONS ARE IN INCHES [MM].

TO 1 DECIMAL PLACE ±.2  
 TO 2 DECIMAL PLACES ±.10  
 AS ANGLES ±

ISSUE	DATE
A	03/05/01
B	09/29/04
C	03/10/08

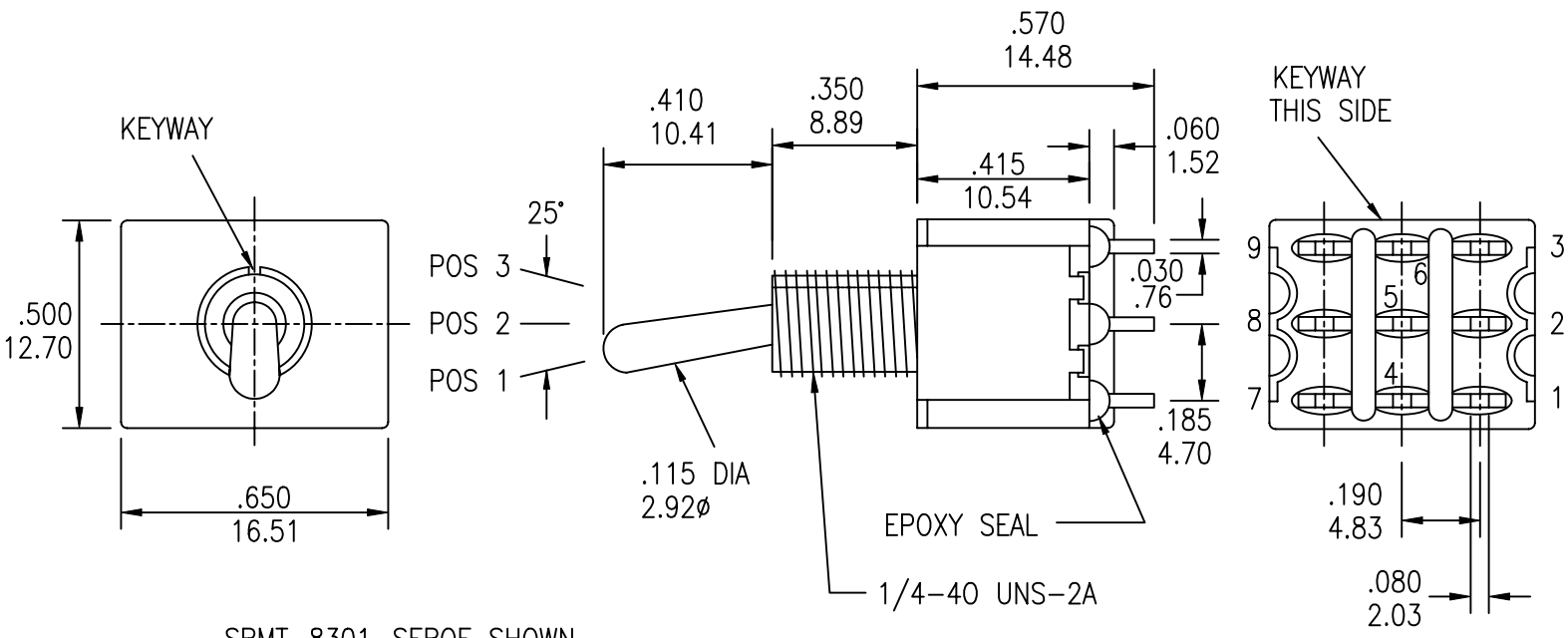

SRMT-8301-SEBQE SHOWN

MODEL NO.	SWITCHING POSITION		
8301	ON	NONE	ON
8303	ON	NONE	MOM
8305	ON	OFF	ON
8307	MOM	OFF	MOM
8309	ON	OFF	MOM
CONN. TERMS	2-3, 5-6 8-9	OPEN	2-1, 5-4 8-7
SCHEMATIC			

NON-SHORTING TYPE

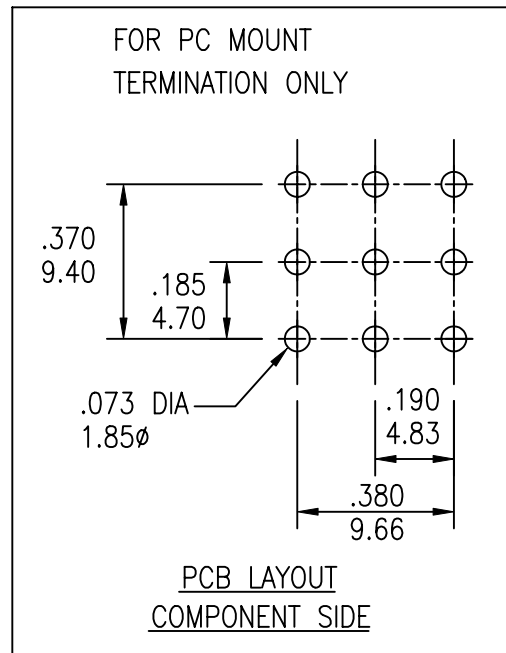

UNLESS OTHERWISE SPECIFIED, ALL DIMENSIONS ARE IN INCHES [MM].

TO 1 DECIMAL PLACE ±.2  
 TO 2 DECIMAL PLACES ±.10  
 AS ANGLES ±

ISSUE	DATE
A	03/05/01
B	09/29/04
C	03/10/08

SPECIFICATIONS

ELECTRICAL

CONTACT RATING:

SILVER: 5A @ 120 VAC OR 28 VDC, 2A @ 250 VAC

GOLD: 0.4 VA MAX. @ 20 V MAX. (AC OR DC)

CONTACT RESISTANCE: 10 MILLIOHMS MAX.

INSULATION RESISTANCE: 1,000 MEGOHMS MIN. AT 500 VDC

DIELECTRIC STRENGTH: 1,000 VRMS

MECHANICAL

LIFE: 40,000 CYCLES

ENVIRONMENTAL

OPERATING TEMPERATURE: -30°C TO +85°C

MATERIAL

CASE: DAP, UL94V-0

HOUSING: STAINLESS STEEL

ACTUATOR: BRASS, CHROME PLATED

BUSHING: BRASS, NICKEL PLATED

SUPPORT: BRASS, TIN PLATED

CONTACT/TERMINALS: COPPER ALLOY, SILVER OR GOLD PLATED

REGULATORY

UL AND CANADA RECOGNIZED COMPONENT. UL/CUL FILE NO. E173084.

PART NUMBER BUILDER:

SERIES	MODEL NO.	ACTUATOR	BUSHING	TERMINATION	CONTACT PLATING	SEAL
SRMT	- [ ] [ ] [ ] [ ] [ ]	- [ ]	[ ]	[ ]	[ ]	[ ]
	8301	S (STD)	BLANK (Z/Z1 ONLY)		Q (SILVER)	BLANK
	8303	T	E (STD - THD)		R (GOLD)	E (EPOXY)
	8305	X (LONG)	E1 (STD - THD) (U ONLY)			
	8307	W (LONG)	E2 (STD - THD) (U ONLY)			
	8309	V (LONG)	M (STD - NON-THD)	B (SOLDER LUG)		
		U (FLATTED)	M1 (STD - NON-THD)(U ONLY)	C (PC MOUNT)		
		Z (LARGE TOGGLE)	M2 (STD - NON-THD)(U ONLY)	D (QUICK CONNECT)		
		Z1 (LARGE)	F (THD)	D1 (WIRE WRAP - .736)		
		Y (PLASTIC)	N (NON-THD)	D2 (WIRE WRAP - .953)		
		LL1 (LOCKING LEVER)	G (HIGH TORQUE)	D3 (WIRE WRAP - .415)		
			H (HIGH TORQUE)	D4 (WIRE WRAP - 1.062)		
			J (LONG)			
			K (METRIC)			
			L (SPLASH-PROOF)			



TITLE: TOGGLE SWITCH		PART NO: SRMT-83XX-XXXXX			
DATE: 03/05/01	DRAWN: RB	CHKD:	SCALE: N/A	SHEET: 2 OF 6	

UNLESS OTHERWISE SPECIFIED, ALL DIMENSIONS ARE IN INCHES [MM].  
 TO 1 DECIMAL PLACE ±.2  
 TO 2 DECIMAL PLACES ±.10  
 AS ANGLES ±

ISSUE	DATE
A	03/05/01
B	09/29/04
C	03/10/08

ACTUATOR OPTIONS

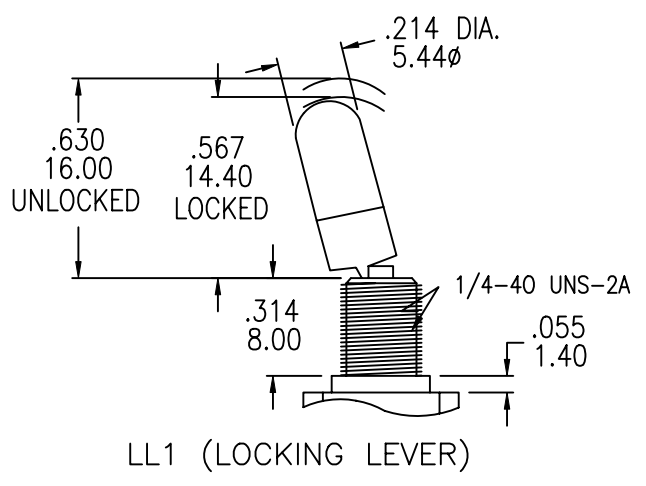
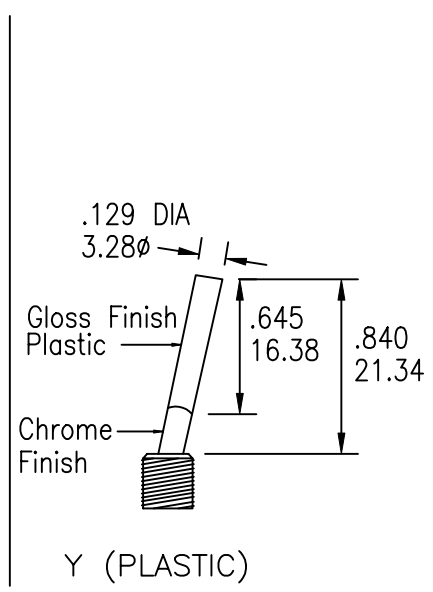
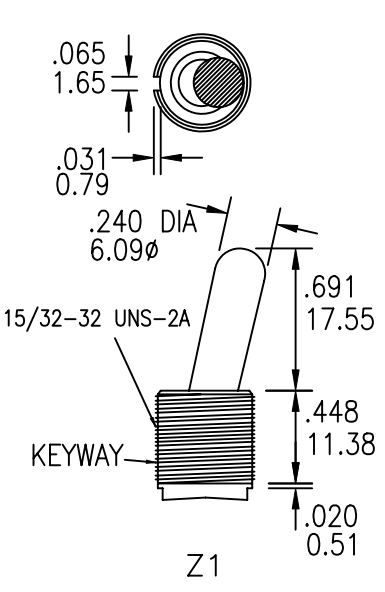
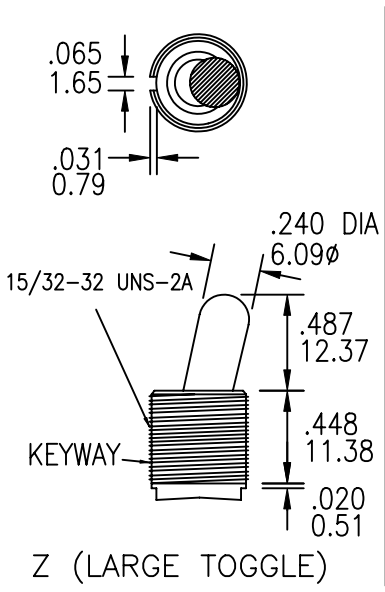
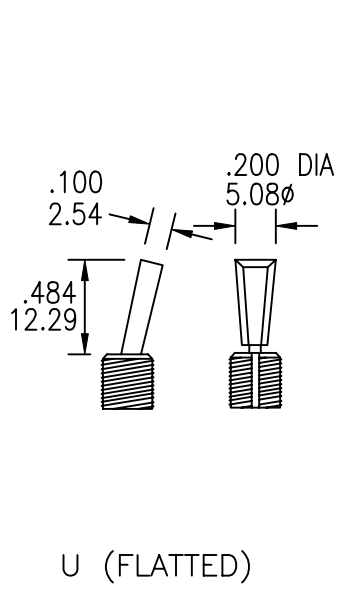
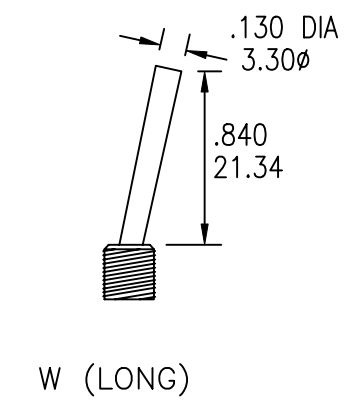
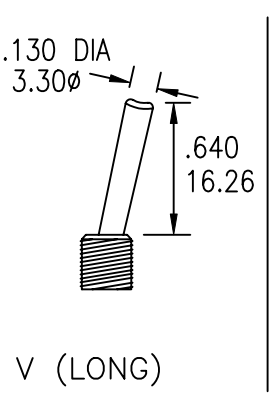
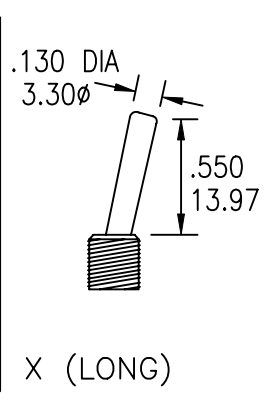
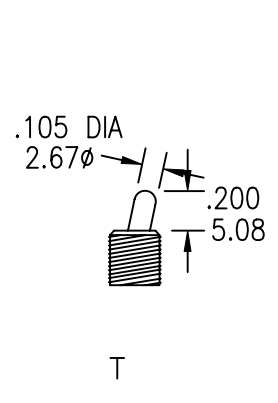
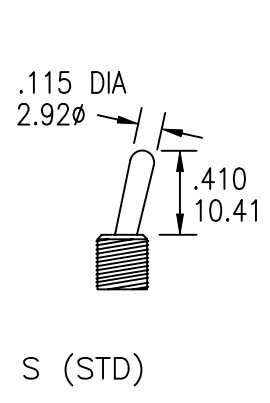

NOTE: OPTIONAL TOGGLE CAP AVAILABLE.

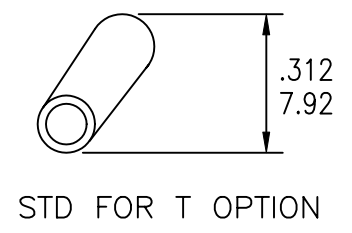
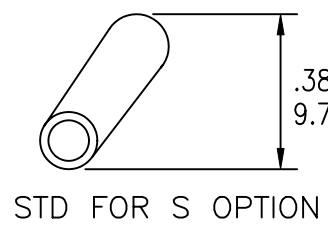

UNLESS OTHERWISE SPECIFIED, ALL DIMENSIONS ARE IN INCHES [MM].

TO 1 DECIMAL PLACE ±.2  
 TO 2 DECIMAL PLACES ±.10  
 AS ANGLES ±

ISSUE	DATE
A	03/05/01
B	09/29/04
C	03/10/08

BUSHING OPTIONS

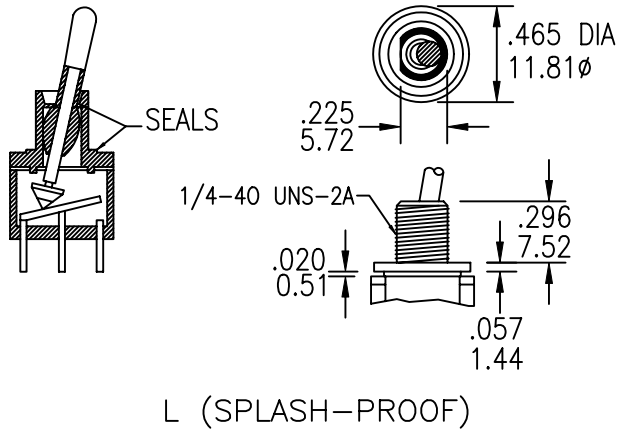
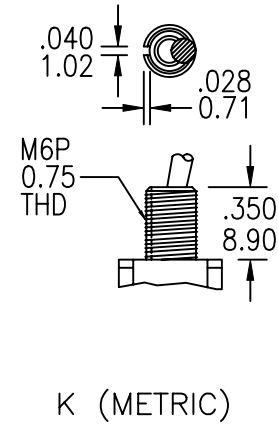
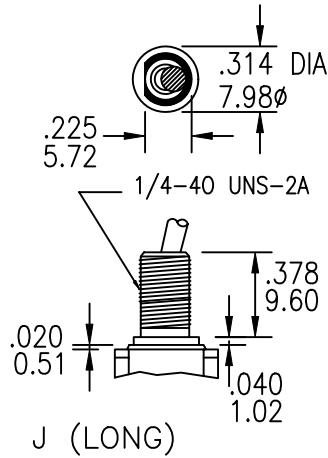
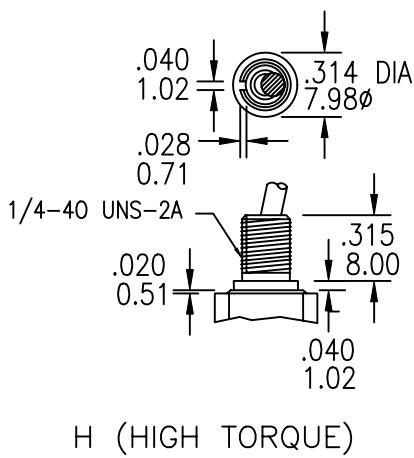
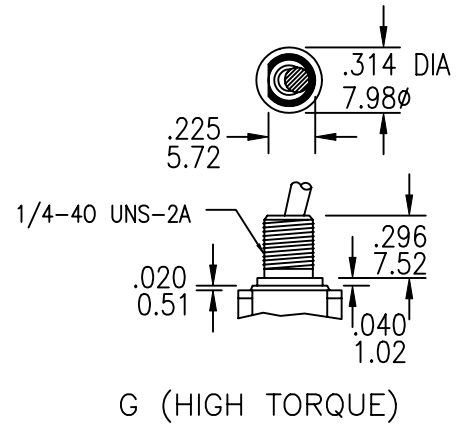
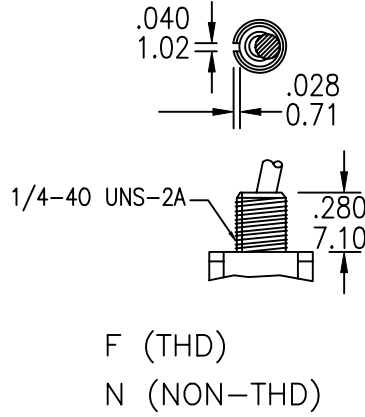
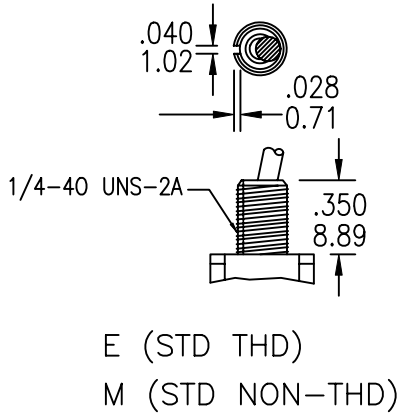

USE WITH 'U' (FLATTED) ACTUATOR ONLY

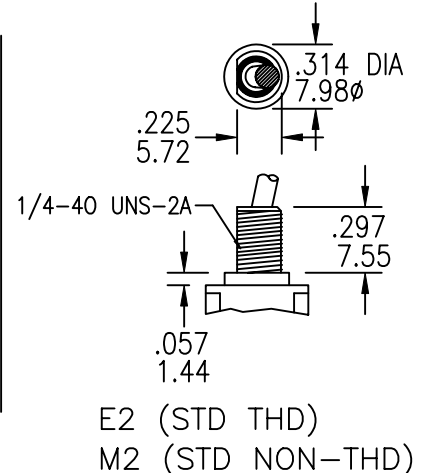
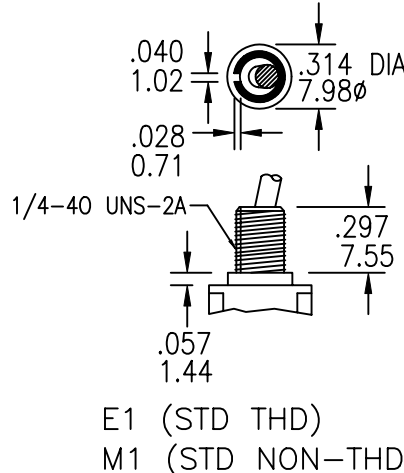

UNLESS OTHERWISE SPECIFIED, ALL DIMENSIONS ARE IN INCHES [MM].

TO 1 DECIMAL PLACE ±.2  
 TO 2 DECIMAL PLACES ±.10  
 AS ANGLES ±

ISSUE	DATE
A	03/05/01
B	09/29/04
C	03/10/08

TERMINATION OPTIONS

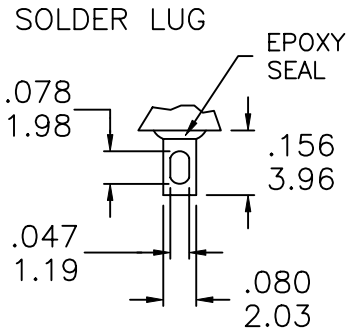

B

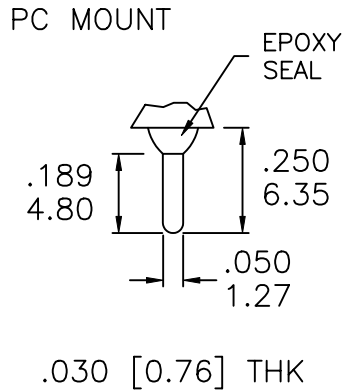

C

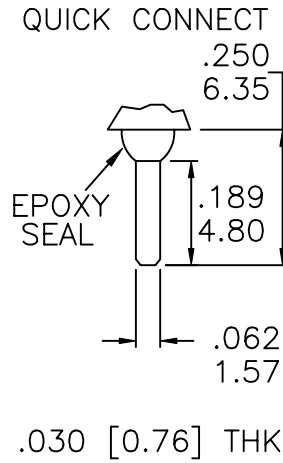

D

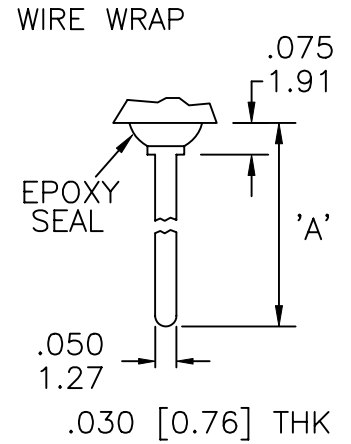

	'A'
D1	.736(18.70)
D2	.953(24.20)
D3	.415(10.54)
D4	1.062(26.97)

UNLESS OTHERWISE SPECIFIED, ALL DIMENSIONS ARE IN INCHES [MM].

TO 1 DECIMAL PLACE ±.2  
 TO 2 DECIMAL PLACES ±.10  
 AS ANGLES ±

ISSUE	DATE
A	03/05/01
B	09/29/04
C	03/10/08

STANDARD NUTS

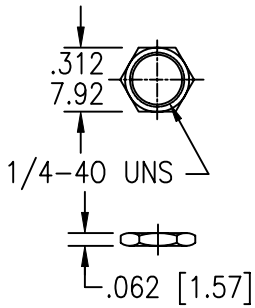

STD FOR E, F, G,  
 H, AND L OPTIONS

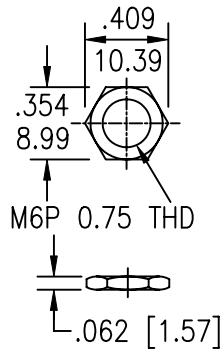

STD FOR K OPTION

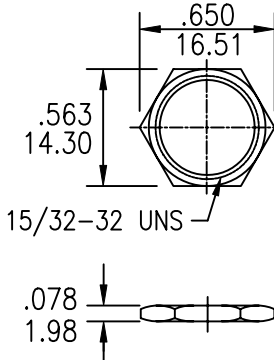

STD FOR Z  
 AND Z1 OPTIONS

OPTIONAL NUTS

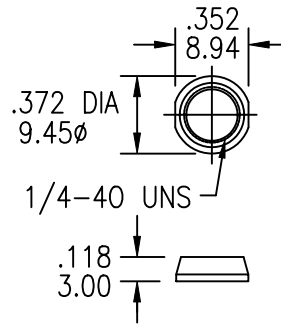

DRESS NUT

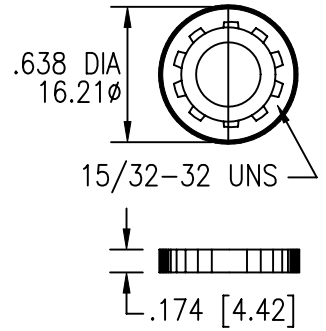

KNURLED

LOCK WASHER

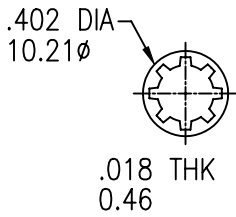

STD FOR E AND F

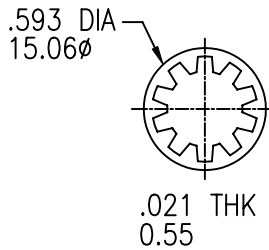

STD FOR Z AND Z1 OPTIONS

LOCKING RING

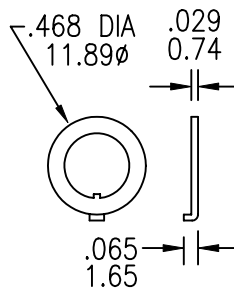

STD

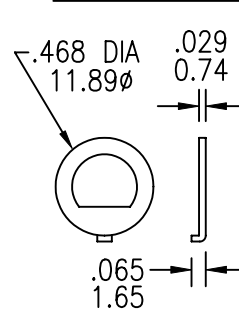

STD FOR G  
 AND J OPTIONS.

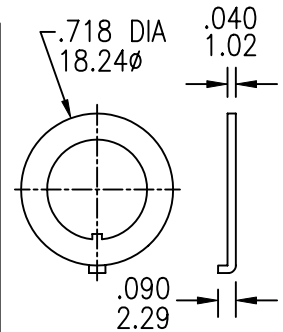

STD FOR Z  
 AND Z1 OPTIONS.

PANEL MOUNTING

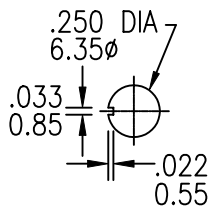

FOR BUSHING E, M, F, N, AND H OPTIONS

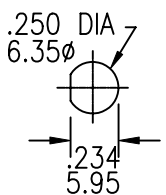
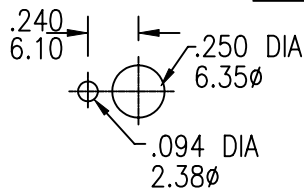

FOR BUSHING G, J, AND L OPTIONS

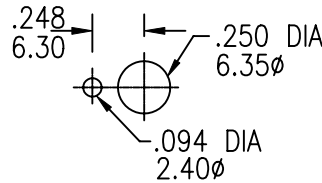
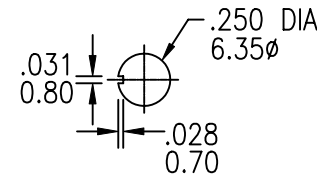

FOR BUSHING K OPTION

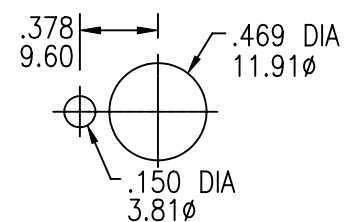
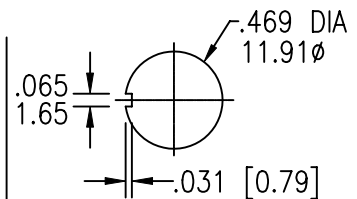

FOR ACTUATOR Z AND Z1 OPTIONS