

1

2

3

4

5

COMPONENT SPECIFICATION

USE OR REPRODUCTION OF THIS DRAWING FOR THE PURPOSE OF MANUFACTURING THIS ARTICLE OR ANY ARTICLES SHOWN FOR ANY PURPOSE IS STRICTLY PROHIBITED WITHOUT WRITTEN PERMISSION FROM SENIOR INDUSTRIES, INC.

SPECIFICATIONS

ELECTRICAL

CONTACT RATING: 50mA Max. @ 12VDC
CONTACT RESISTANCE: 50 MILLIOHMS MAX.
INSULATION RESISTANCE: 100 MEGOHMS MIN. @ 100 VDC
DIELECTRIC STRENGTH: 250 VAC FOR 1 MINUTE

MECHANICAL

OPERATING LIFE: 100,000 CYCLES
OPERATING FORCE: 120 gf ±30gf
TRAVEL: 0.25 ±0.1mm

MECHANICAL

FRAME: STEEL TIN PLATED
HOUSING: NYLON 6/6 G30 UL94V-0, BLACK
ACTUATOR: NYLON 6/6 G30 UL94V-0, BLACK
CONTACT: PHOSPHOR BRONZE, SILVER PLATED
TERMINAL: BRASS, SILVER PLATED

ENVIRONMENTAL

OPERATING TEMPERATURE: -20°C TO +70°C
STORAGE TEMPERATURE: -30°C TO +80°C

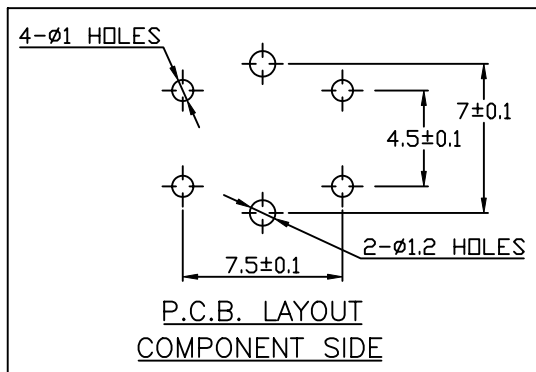
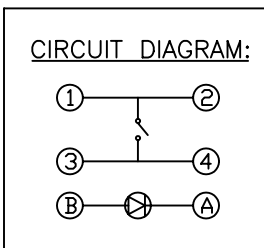
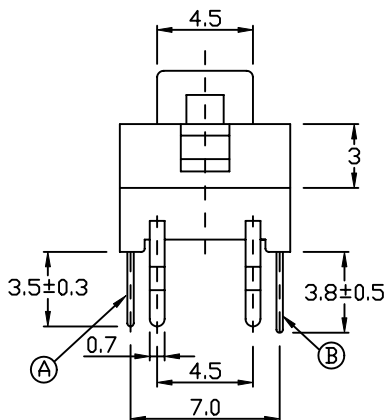
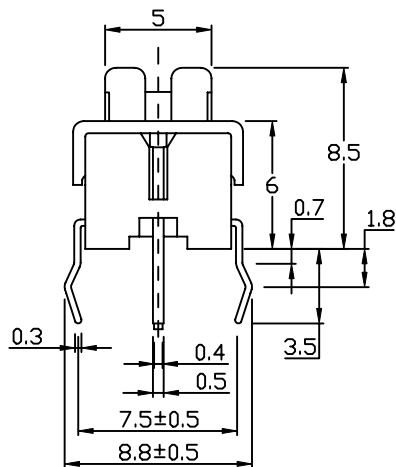
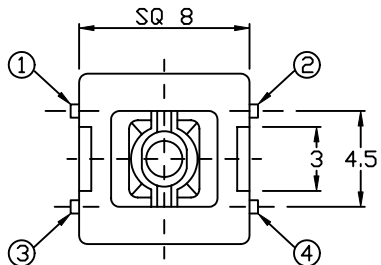

NOTE: "X" IN PART NUMBER DENOTES LED COLOR:
1 - RED; 2 - GREEN; 3 - YELLOW



SENIOR INDUSTRIES, INC.

Table with columns: DESIGNED, DRAWN, CHECKED, APPROVED, SYM, DATE, DESCRIPTION OF REVISIONS, DRAWN, APPD, 3RD ANGLE, UNIT, mm, SCALE, 1:1, REV., B

Table with columns: TOLERANCE, PART NO, TITLE, SHEET, TO 1 DECIMAL PLACE: ±.3, TO 2 DECIMAL PLACES: ±.12, AS ANGLES: ±1/2°, SRPK-816-X, PUSHBUTTON SWITCH, 1 OF 1