

1

2

3

4

5

COMPONENT SPECIFICATION

USE OR REPRODUCTION OF THIS DRAWING FOR THE PURPOSE OF MANUFACTURING THIS ARTICLE OR ANY ARTICLES SHOWN FOR ANY PURPOSE IS STRICTLY PROHIBITED WITHOUT WRITTEN PERMISSION FROM MACLEAN SENIOR INDUSTRIES, LLC

SPECIFICATIONS

MECHANICAL

WIRE RANGE
STUD TORQUE
SET SCREW TORQUE
AGENCY APPROVAL

#14-#6 AWG COPPER WIRE
120 IN-LBS MAX.
30 IN-LBS MAX.
UL/CUL FILE E137523

MATERIAL

BODY
STUD
GROUND SCREW

COPPER ALLOY
STEEL, ZINC PLATED
STEEL, ZINC PLATED

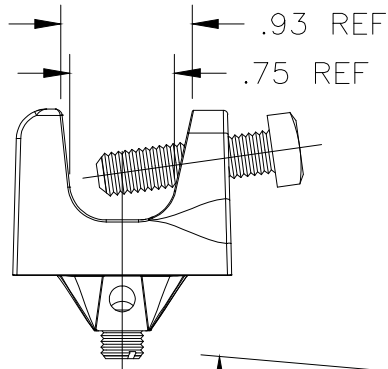

STUD

1.175 REF

.95 REF

1.56 REF

BODY

GROUND SCREW



DESIGNED:			SYM.	DATE:	DESCRIPTION OF REVISIONS:	DRAWN:	APPD:
DRAWN:	MAW	03/30/17	▲	03.30.17	NEW	MAW	JF
CHECKED:	MAW	03/30/17	▲	. . .			
APPROVED:	JF	03/30/17	▲	. . .			
3RD ANGLE		UNIT:	inches	SCALE:	2:1	REV.	A

TOLERANCE:	PART NO:	SI-2181
TO 2 DECIMAL PLACES: ±	TITLE:	BEAM CLAMP
TO 3 DECIMAL PLACES: ±	SHEET:	1 OF 1
AS ANGLES: ± °		